

도어 왼쪽부터 2200mm 철거

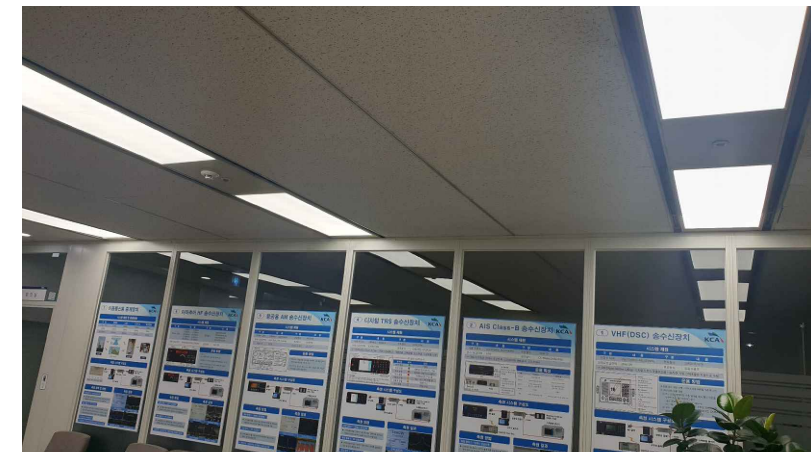

S.G.P 벽체 철거

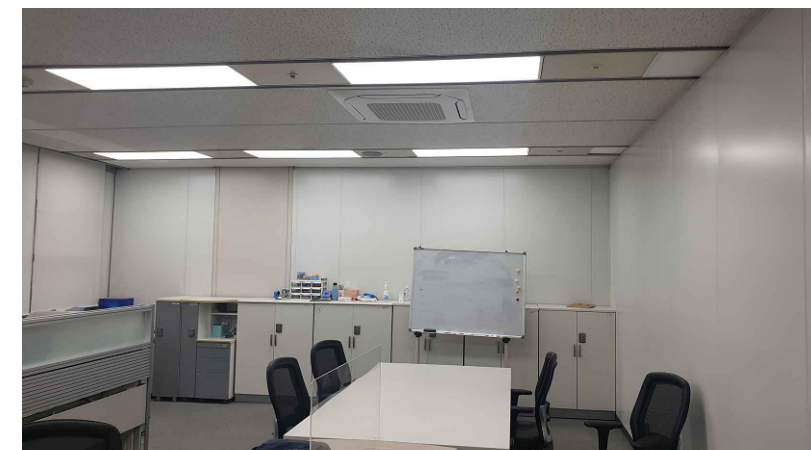

S.G.P 벽체 철거

CONSULTANT	<div>designBADA</div> <div>Interior &amp; Architecture</div> <div>ADD : 서울 강남구 양재대로55길 29 6층</div> <div>Tel : 02-2232-3621</div> <div>Fax : 02-2232-3620</div> <div>E-mail : design-bada@daum.net</div>	PROJECT TITLE	한국방송통신전파진흥원 서울본부	DRAWING TITLE	철거안내도	PLOT SCALE	A1	—	DATE	2021. 08	SHEET NO.	A-111	
						A3	1 / 150						
						CHECKED BY						—	

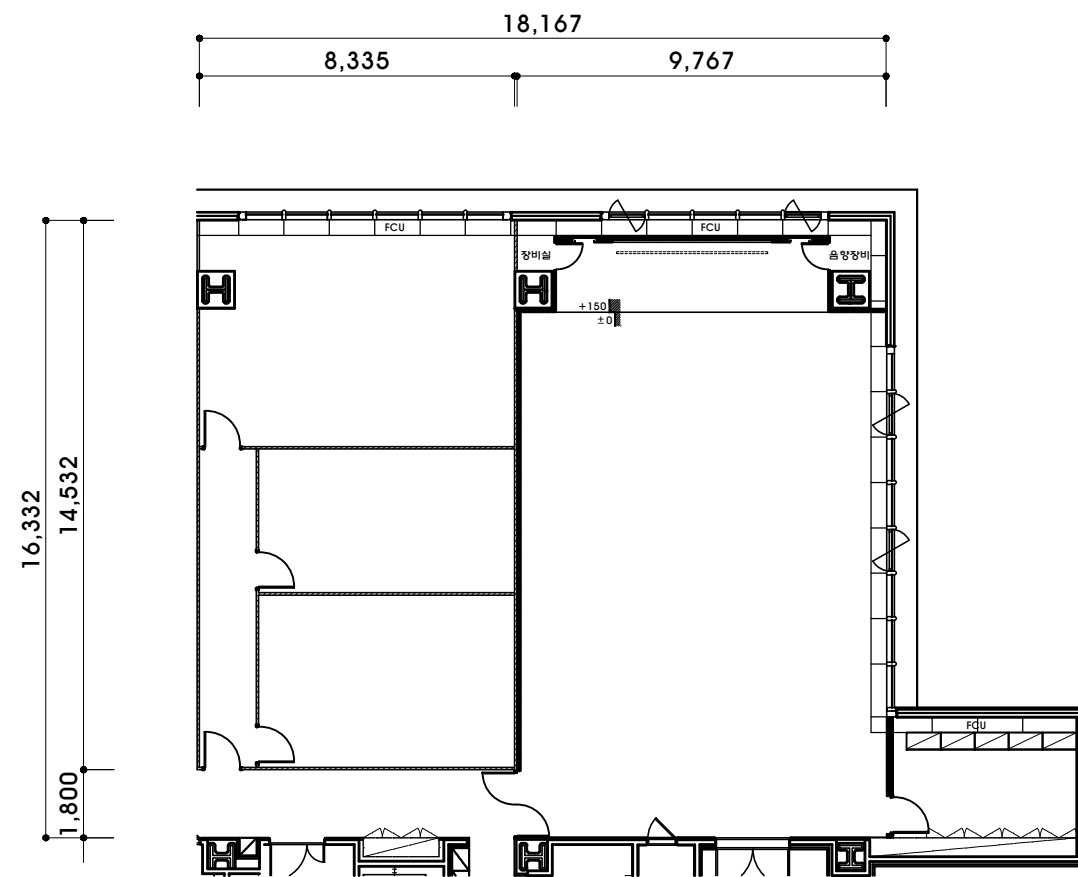

변경 전

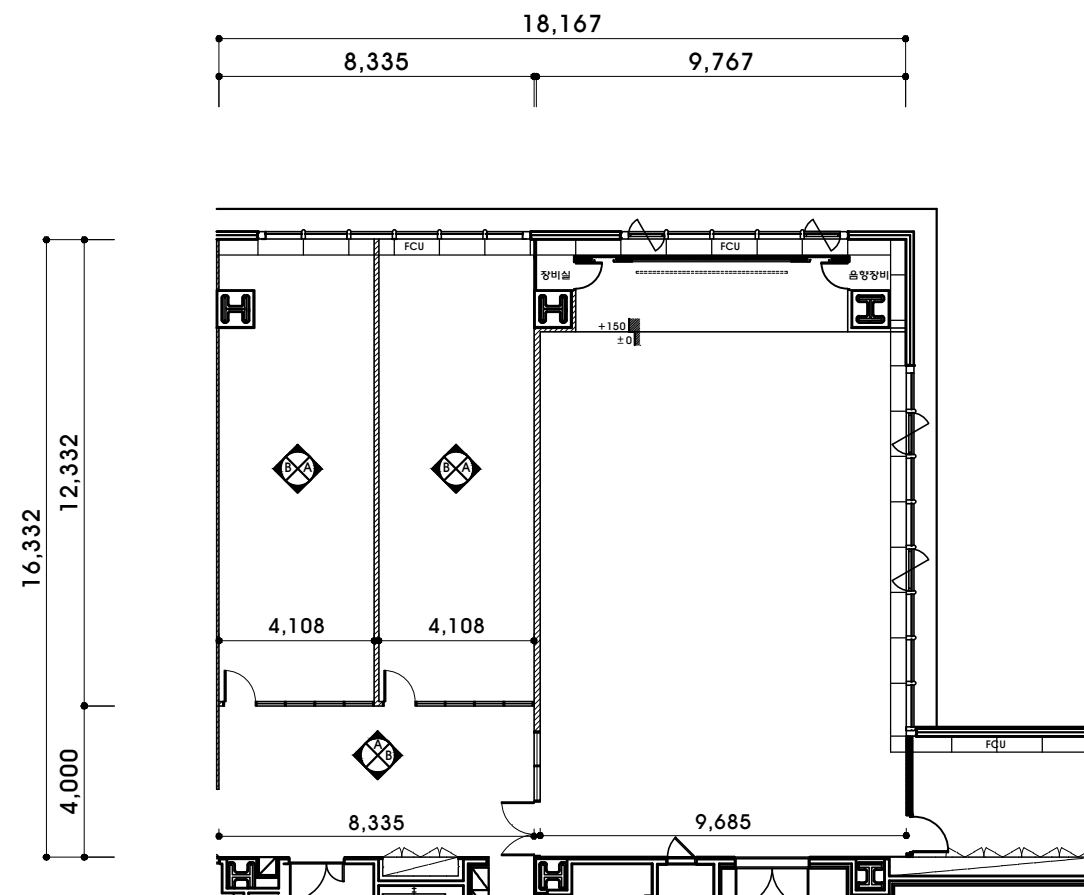

변경 후

CONSULTANT

**designBADA**  
Interior & Architecture

ADD : 서울 강남구 양재대로55길 29 6층  
Tel : 02-2232-3621  
Fax : 02-2232-3620  
E-mail : design-bada@daum.net

PROJECT TITLE

한국방송통신전파진흥원 서울본부

DRAWING TITLE

평면도

PLOT SCALE

A1

—

DATE

2021. 08

SHEET NO.

A-112

CHECKED BY

—

DRAWN BY

Jh,song

APPROVE

—

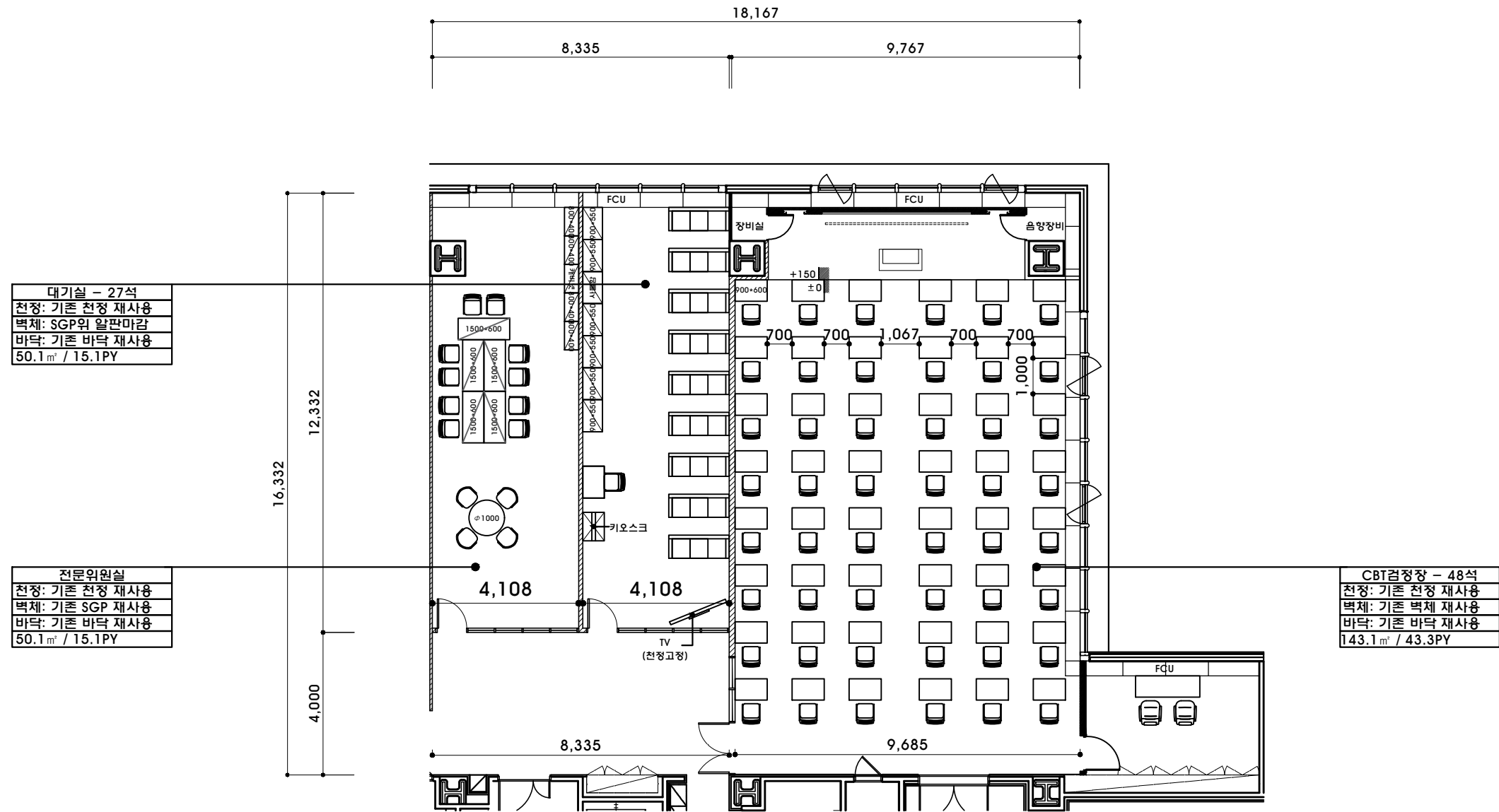

CONSULTANT

**designBADA**  
Interior & Architecture

ADD : 서울 강남구 양재대로55길 29 6층  
Tel : 02-2232-3621  
Fax : 02-2232-3620  
E-mail : design-bada@daum.net

PROJECT TITLE

한국방송통신전파진흥원 서울본부

DRAWING TITLE

가구배치도

PLOT SCALE

A1

—

DATE

2021. 08

SHEET NO.

A-113

CHECKED BY

—

DRAWN BY

Jh,song

APPROVE

—

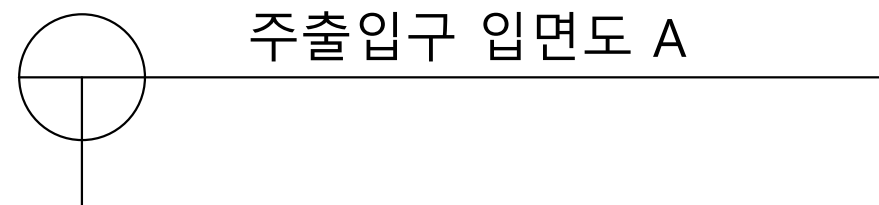
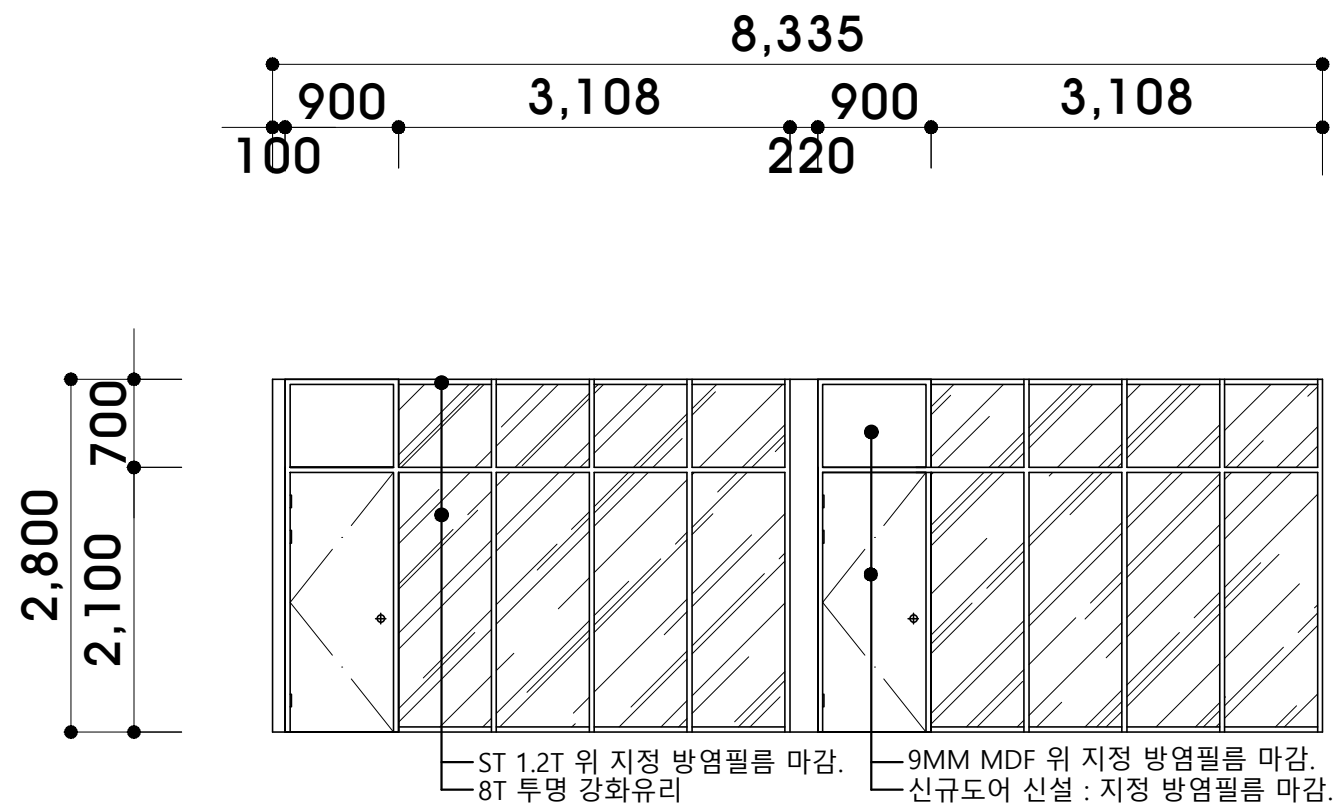

주출입구 입면도 A

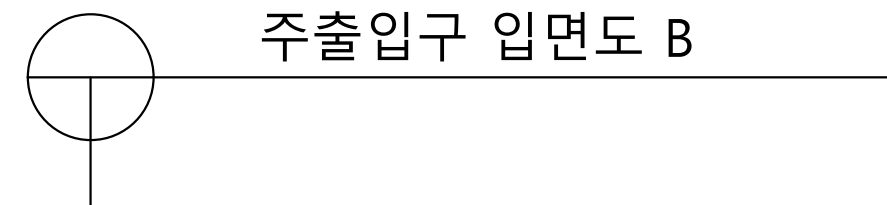
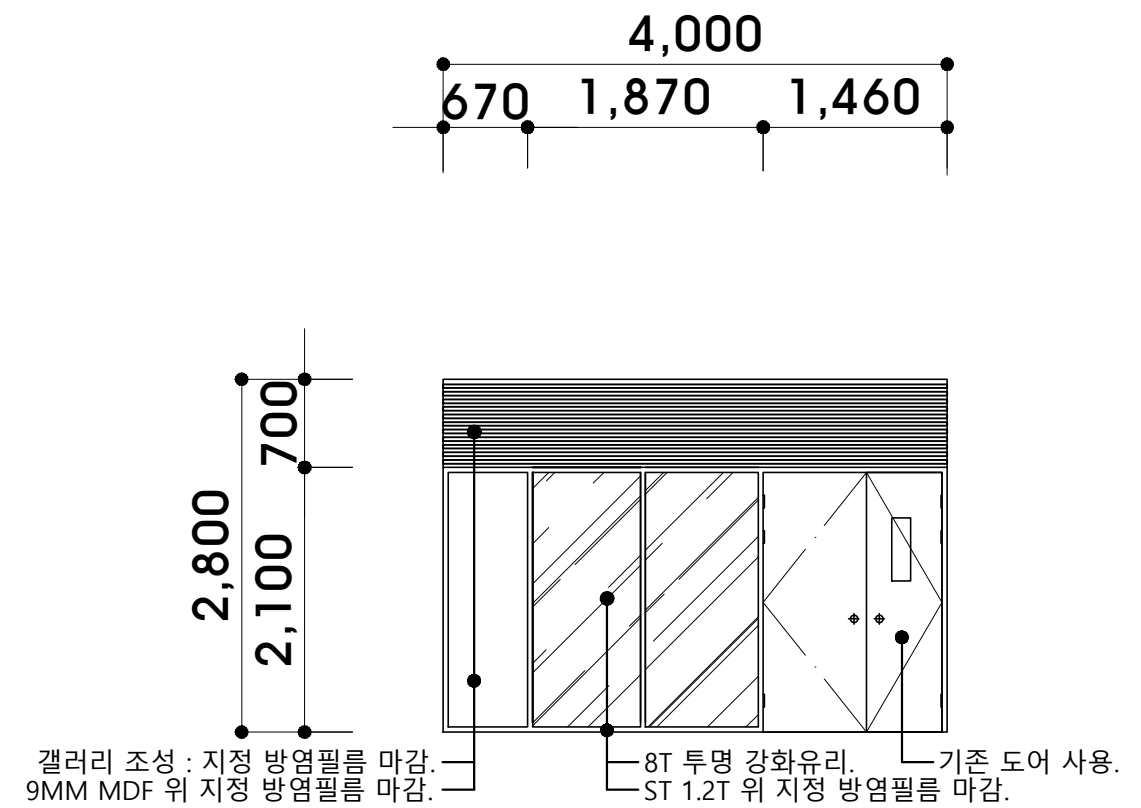

주출입구 입면도 B

CONSULTANT

**designBADA**  
Interior & Architecture

ADD : 서울 강남구 양재대로55길 29 6층  
Tel : 02-2232-3621  
Fax : 02-2232-3620  
E-mail : design-bada@daum.net

PROJECT TITLE

한국방송통신전파진흥원 서울본부

DRAWING TITLE

입면전개도-1

PLOT SCALE

A1

-

DATE

2021. 08

SHEET NO.

A-114

CHECKED BY

A3

1 / 60

DRAWN BY

Jh,song

APPROVE

-

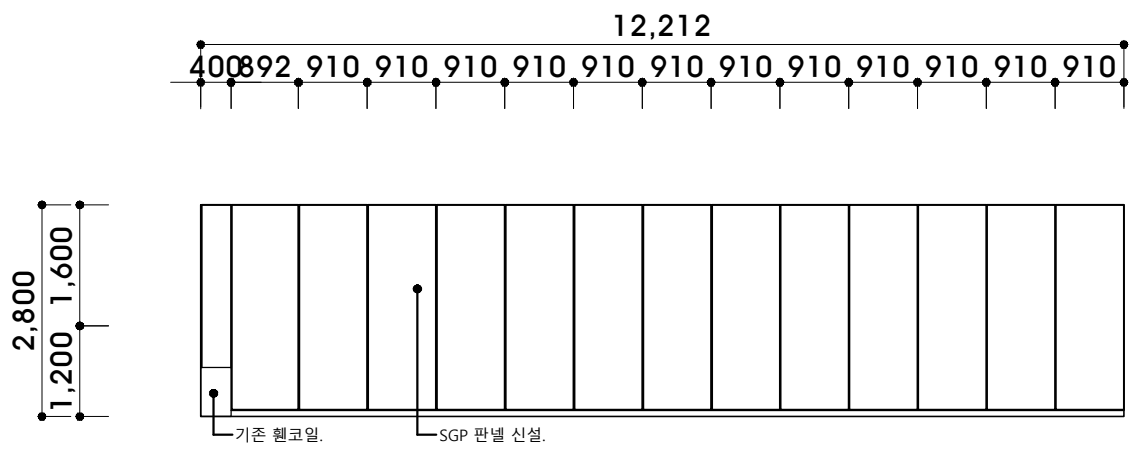

전문위원실 입면도 A

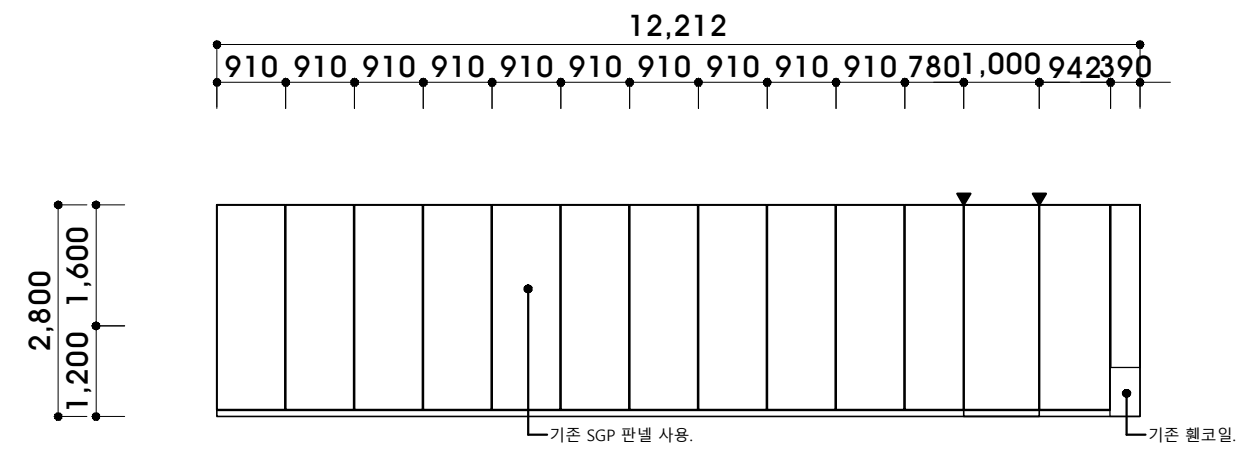

전문위원실 입면도 B

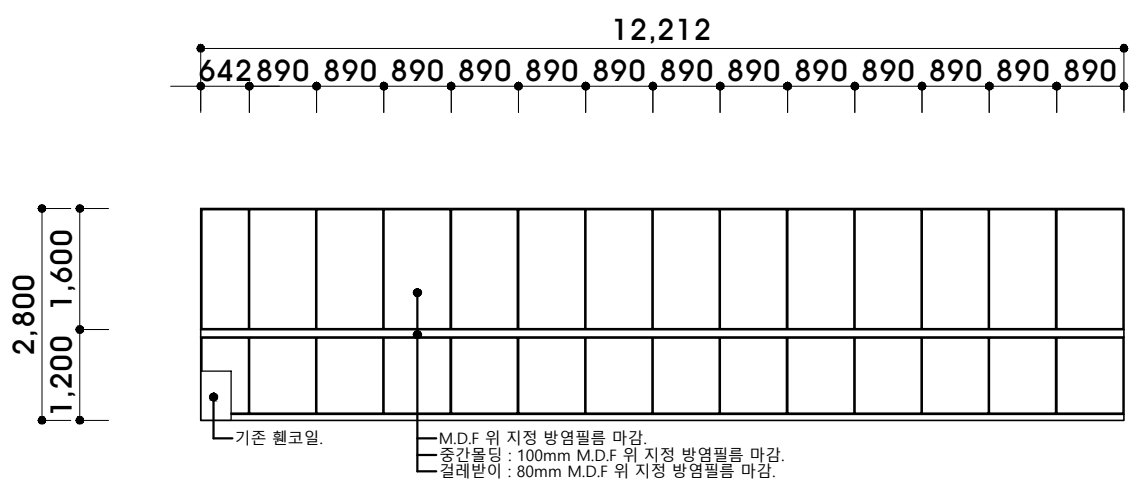

대기실 입면도 A

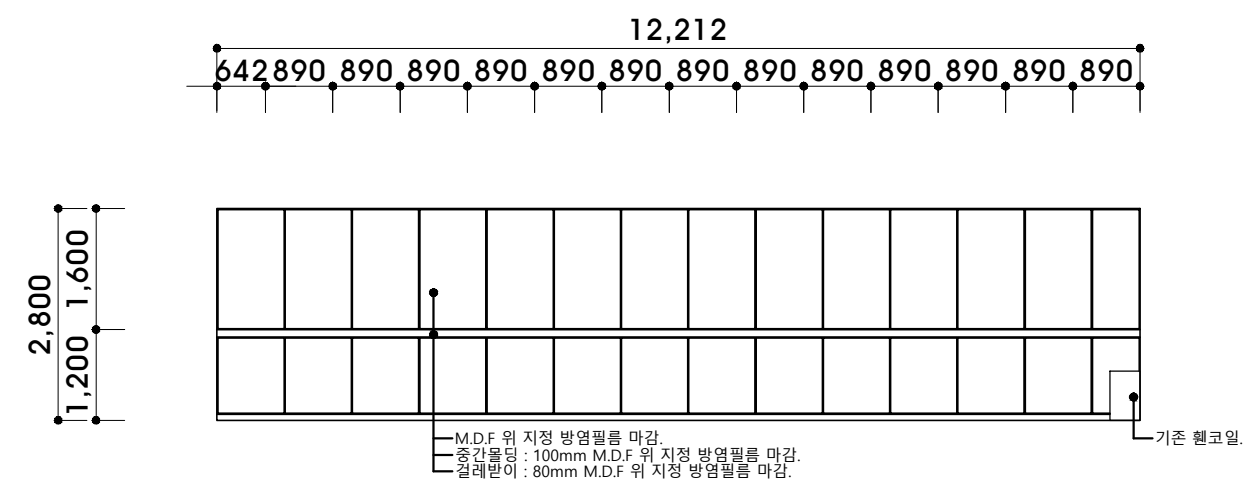

대기실 입면도 B

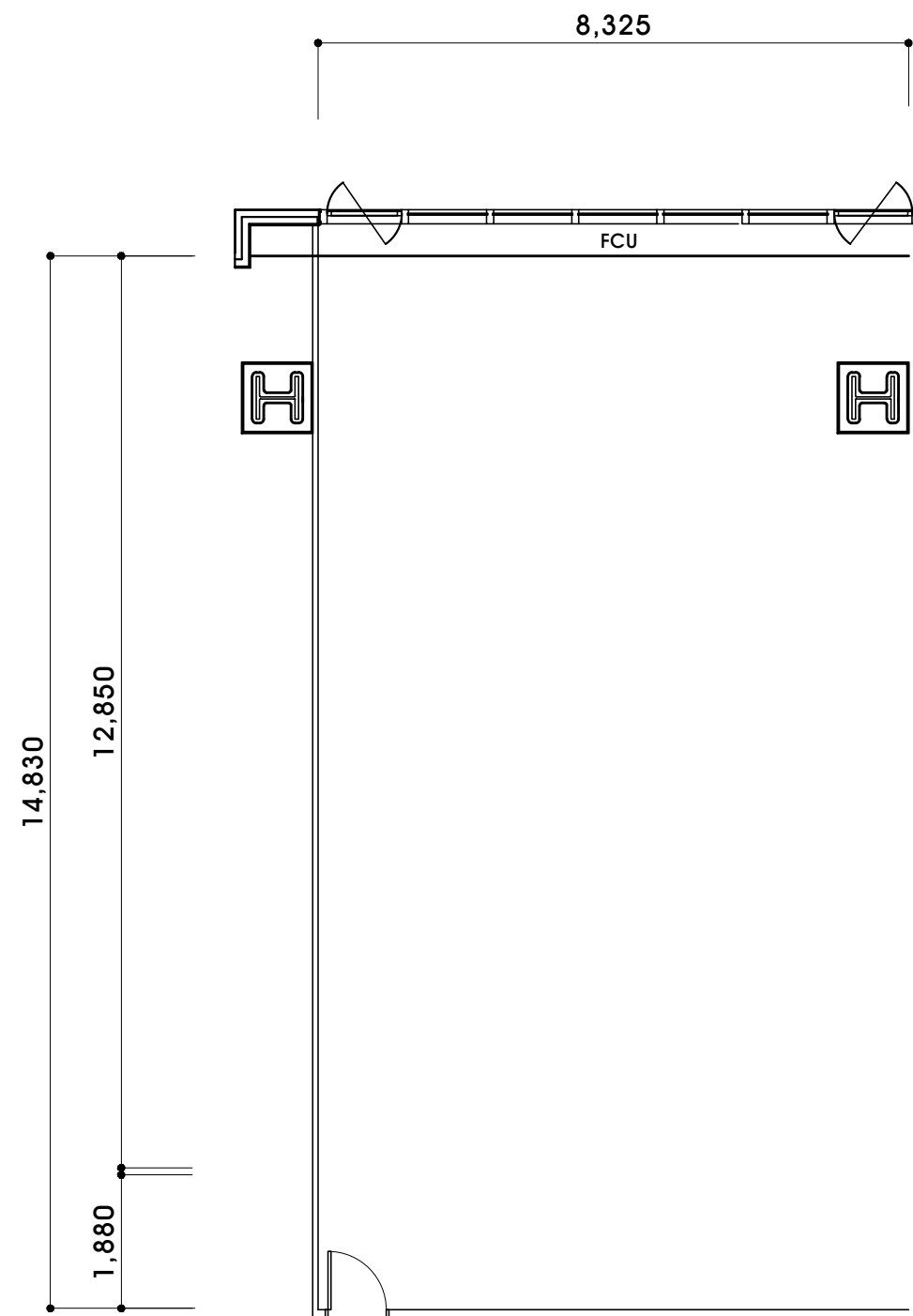

변경 전

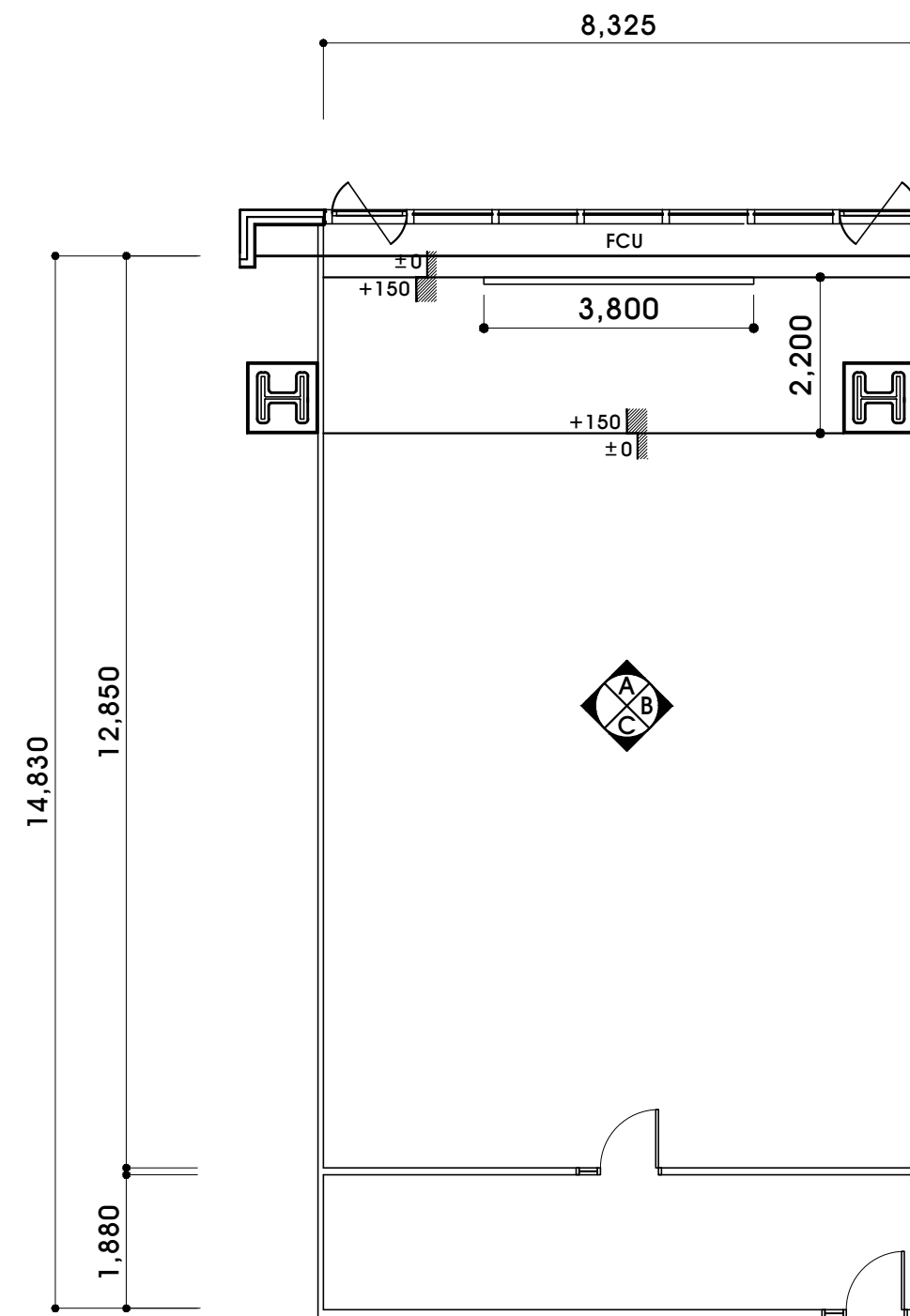

변경 후

CONSULTANT

**designBADA**  
Interior & Architecture

ADD : 서울 강남구 양재대로55길 29 6층  
Tel : 02-2232-3621  
Fax : 02-2232-3620  
E-mail : design-bada@daum.net

PROJECT TITLE

한국방송통신전파진흥원 서울본부

DRAWING TITLE

평면도

PLOT SCALE

A1

—

DATE

2021. 08

SHEET NO.

A-211

CHECKED BY

—

DRAWN BY

Jh,song

APPROVE

—

실기검정실 - 20석
천정: 기존 천정 재사용
벽체: SGP 신설
바닥: 기존 바닥 재사용
110.6㎡ / 33.5PY

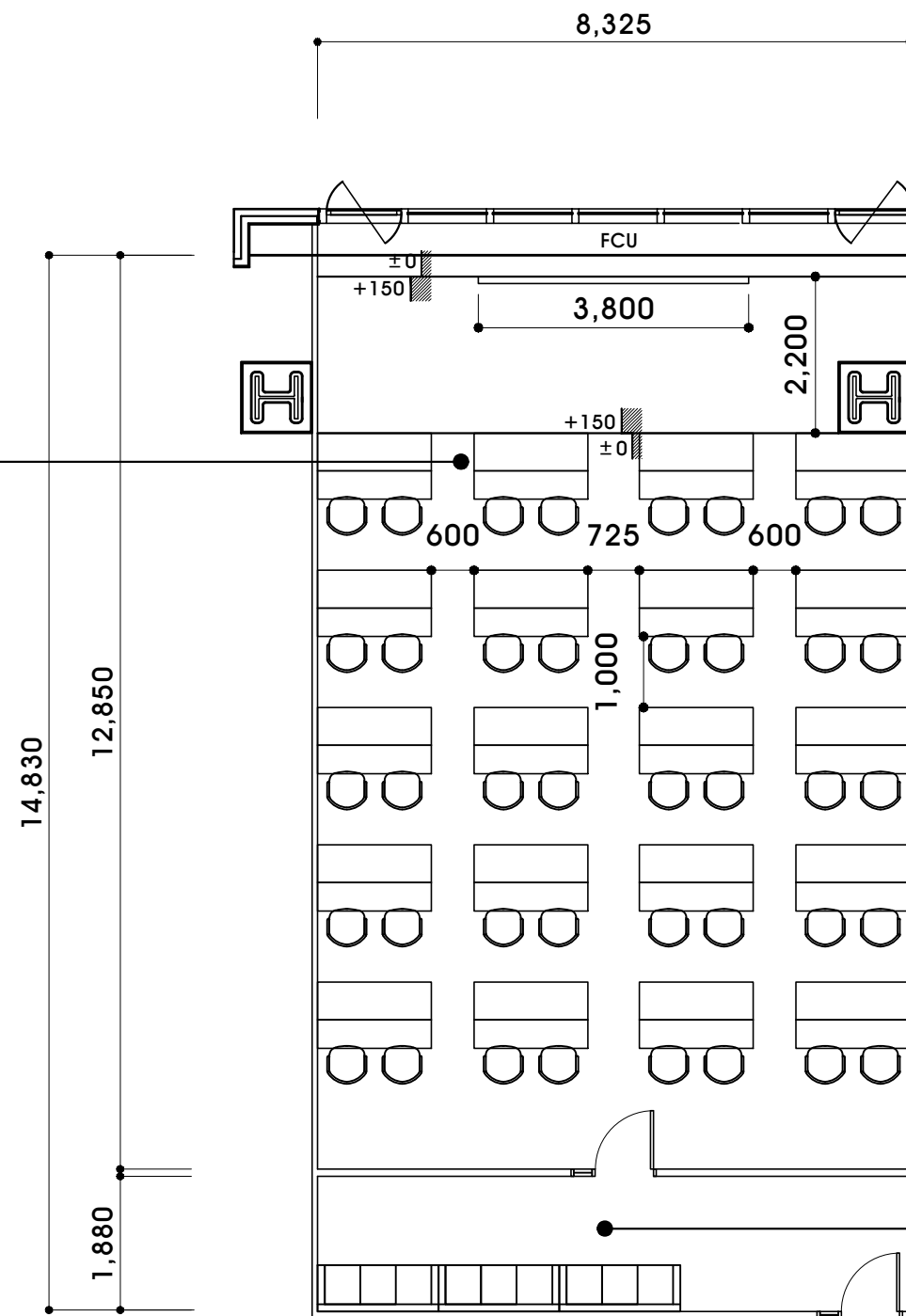

대기실 - 9석
천정: 기존 천정 재사용
벽체: 석고보드 위 흡음보드 마감
바닥: 기존 바닥 재사용
16.2㎡ / 4.9PY

<div>CONSULTANT</div> <div><div>designBADA</div><div>Interior &amp; Architecture</div></div> <div>ADD : 서울 강남구 양재대로55길 29 6층 Tel : 02-2232-3621 Fax : 02-2232-3620 E-mail : design-bada@daum.net</div>	<div>PROJECT TITLE</div> <div>한국방송통신전파진흥원 서울본부</div>	<div>DRAWING TITLE</div> <div>가구배치도</div>	<div>PLOT SCALE</div> <div>A1</div> <div>—</div>	<div>DATE</div> <div>2021. 08</div>	<div>SHEET NO.</div> <div>A-213</div>
			<div>A3</div> <div>1/100</div>		
			<div>CHECKED BY</div> <div>—</div>	<div>DRAWN BY</div> <div>Jh,song</div>	<div>APPROVE</div> <div>—</div>

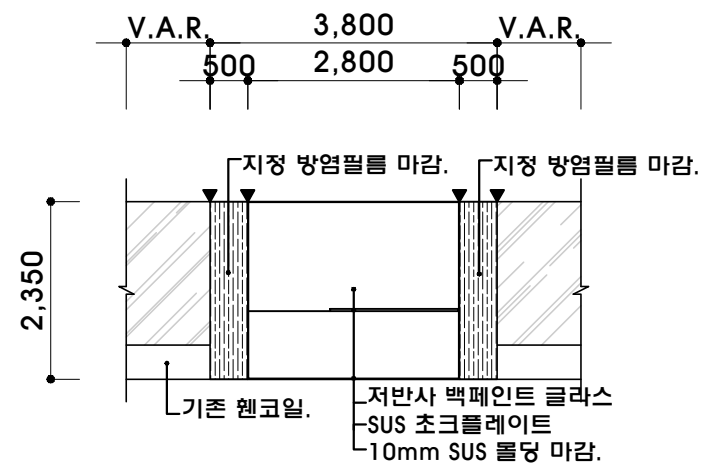

실기검정실 입면도A

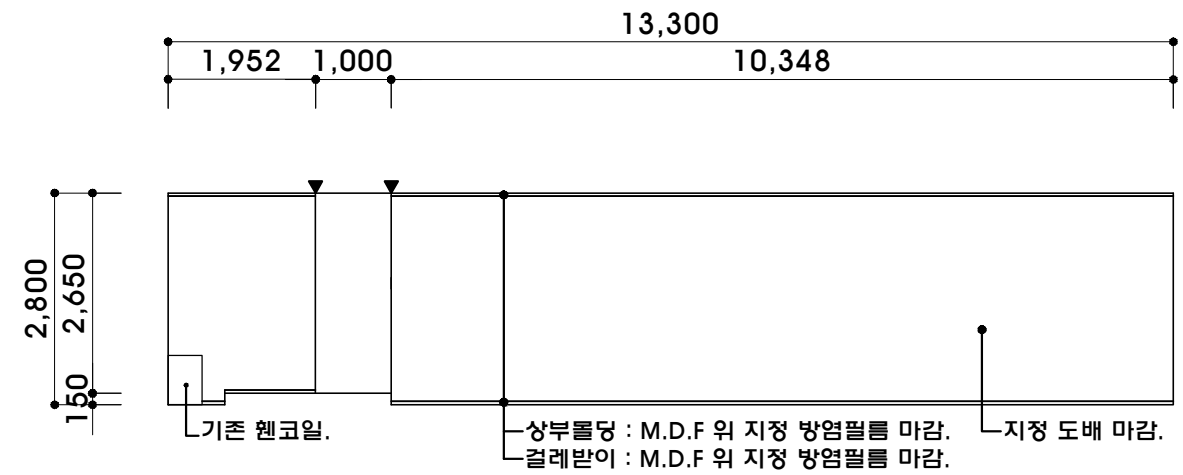

실기검정실 입면도B

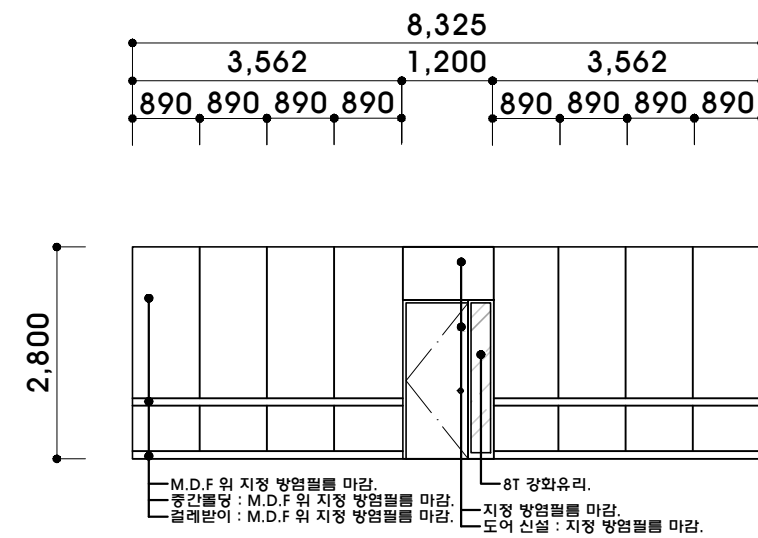

실기검정실 입면도C

CONSULTANT

**designBADA**  
Interior & Architecture

ADD : 서울 강남구 양재대로55길 29 6층  
Tel : 02-2232-3621  
Fax : 02-2232-3620  
E-mail : design-bada@daum.net

PROJECT TITLE

한국방송통신전파진흥원 서울본부

DRAWING TITLE

입면전개도-1

PLOT SCALE

A1

-

DATE

2021. 08

SHEET NO.

A-214

CHECKED BY

A3

1 / 100

DRAWN BY

Jh,song

APPROVE

-